

版本	变更摘要	日期
0	新产品发行	2015/1/28
1	设变除芯罩与吸盘结构 (Plastic Core And Cap Structure)	2016/5/23

序号	品名	材质
①	A型立式WIRE吸芯罩 Board Housing (H=4.9)	LCP U994-0 本色 Natural
②	A型立式WIRE端子 1.25 Pitch S/T Wire To Board Terminal (H=4.9)	铜合金/表面镀锡 Copper Alloy/ Tin Plating
③	A型立式WIRE焊片 1.25 Pitch S/T Wire To Board Fitting Nail (H=4.9)	铜合金/表面镀锡 Copper Alloy/ Tin Plating

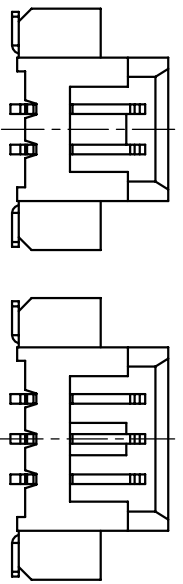
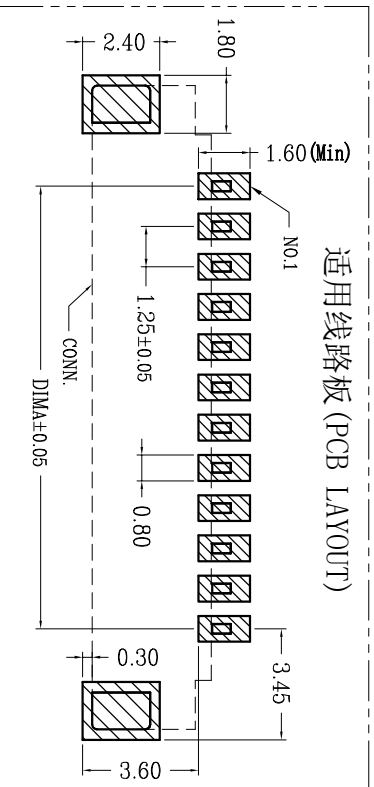
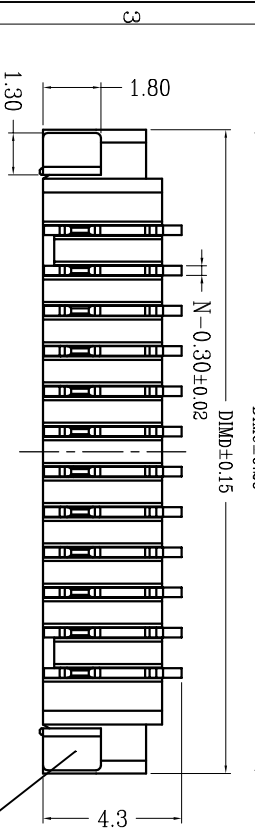
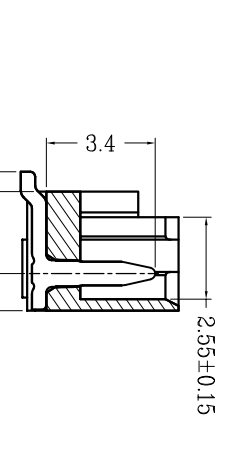
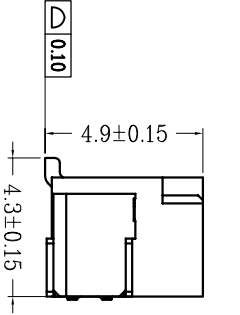
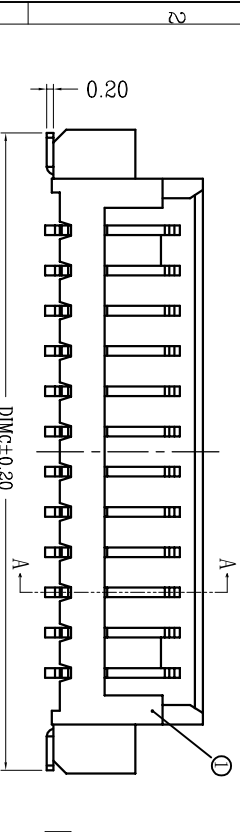
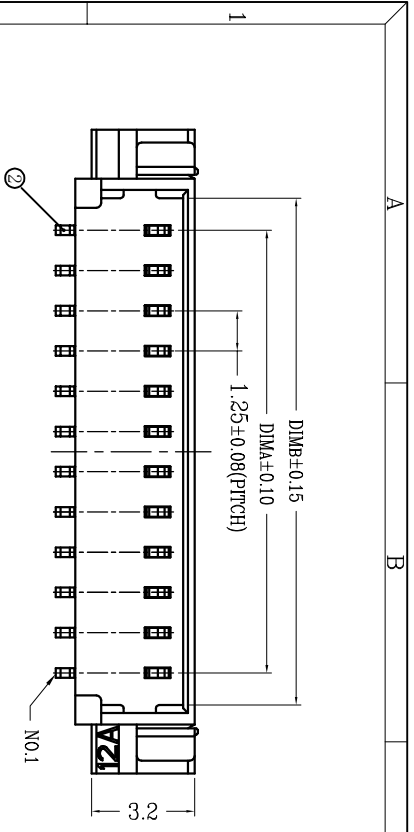
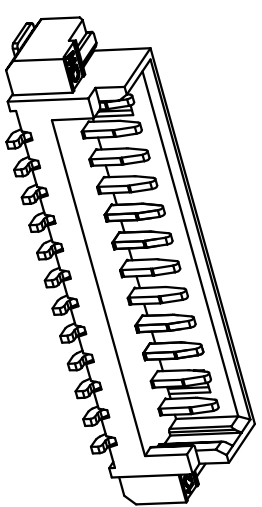

技术指标 (Technical Index):

1. 塑件表面应光洁、无毛边、无明显收缩、缺陷、裂纹等现象。(The surface of the plastic parts should be smooth, no rough edges, no obvious shrinkage, defects, cracks and other phenomena)
2. 锁扣窗口: 2~3PIN为1个, ≥4PIN为2个。(Lock Configuration: 2 to 3Pin is 1, ≥4Pin is 2)
3. 不同Pin位吸盖加入/取出力有差异, 实属正常现象。(It is normal that there are differences between suction cap and suction cap at different Pin positions)
4. 温度范围 (Temperature range): -25° C~85° C.
5. 额定电压 (Rated voltage): 125V, AC/DC (=等效).
6. 接触电阻 (Contact resistance): ≤0.02 Ω.
7. 绝缘电阻 (Insulation resistance): ≥100M Ω.

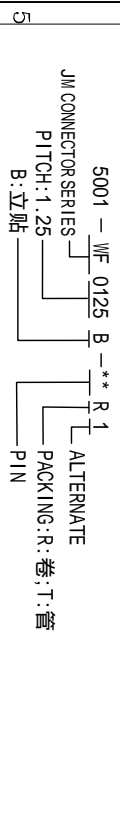

CKT	DIM A	DIM B	DIM C	DIM D
2	1.25	3.25	7.30	7.50
3	2.50	4.50	8.55	8.75
4	3.75	5.75	9.80	10.00
5	5.00	7.00	11.05	11.25
6	6.25	8.25	12.30	12.50
7	7.50	9.50	13.55	13.75
8	8.75	10.75	14.80	15.00
9	10.00	12.00	16.05	16.25
10	11.25	13.25	17.30	17.50
11	12.50	14.50	18.55	18.75
12	13.75	15.75	19.80	20.00
13	15.00	17.00	21.05	21.25
14	16.25	18.25	22.30	22.50
15	17.50	19.50	23.55	23.75
16	18.75	20.75	24.80	25.00
17	20.00	22.00	26.05	26.25
18	21.25	23.25	27.30	27.50
19	22.50	24.50	28.55	28.75
20	23.75	25.75	29.80	30.00

深圳市文章济美科技有限公司



一般公差 (TOLERANCE)
X ±.50 XX ±.10
ANGLES ±1°

品名 (TITLE)	1.25 Pitch A型立式WIRE	料号 (DRAWING)	5001-WF0125B-**-R1-00
比例 (SCALE)	1:1	单位 (UNITS)	mm
审核 (CHECK)	李绍宗	张数 (SHEET)	1 Of 1
制图 (DWG)	ANLAN	尺寸 (SIZE)	A4
校对 (CHKD)	李绍宗	版数 (REV)	A
审核 (APPD)	黄志明		